

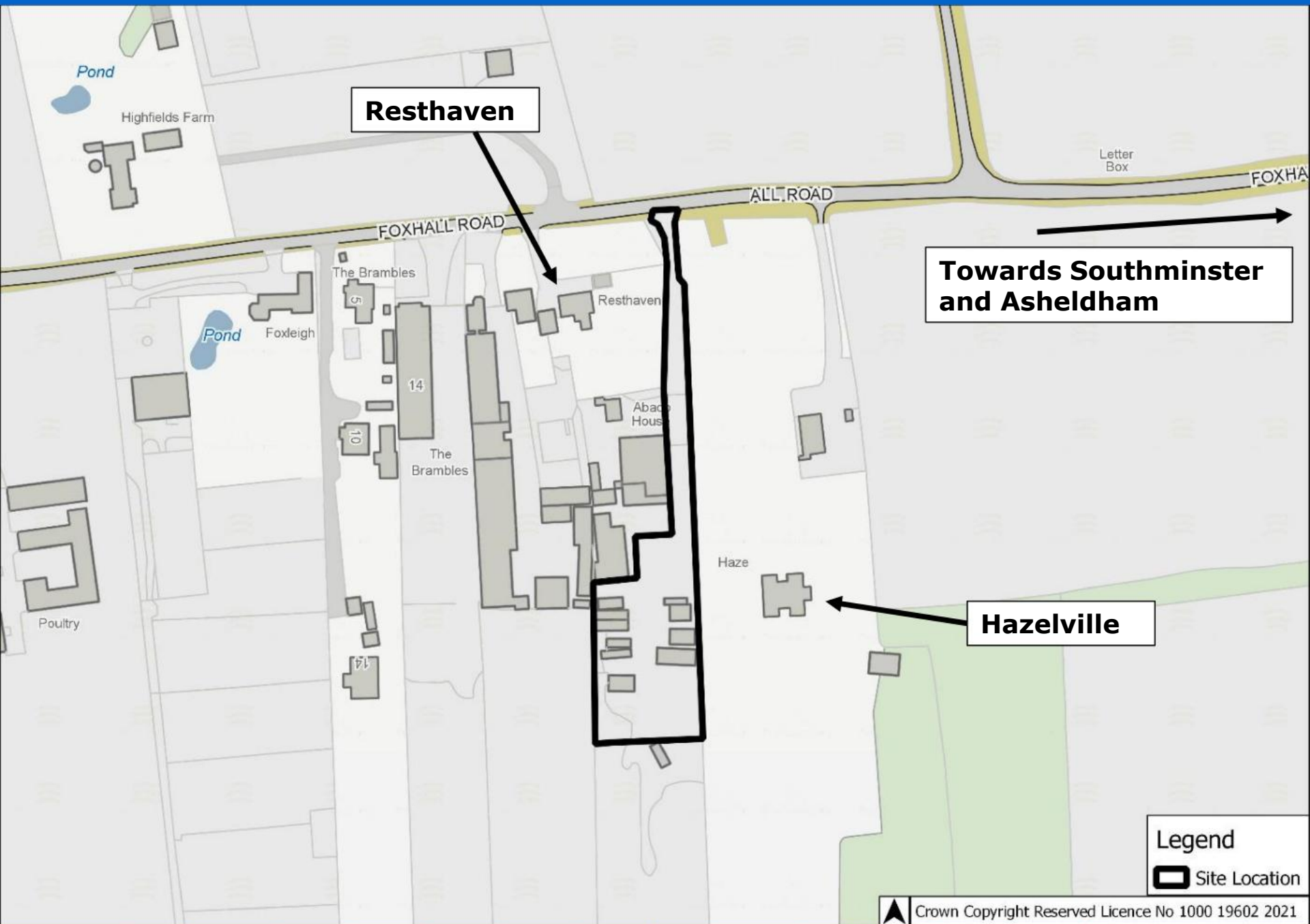

Development and Regulation Committee

**Abaco House,
Foxhall Road, Southminster
ESS/119/20/MAL**



Resthaven

FOXHALL ROAD

ALL ROAD

Letter
Box

FOXHA

**Towards Southminster
and Asheldham**

Hazelville

Legend
Site Location



**Site entrance, looking south.
Abaco Transport Ltd building in
view**



SECOND SCHEDULE - LDE/MAL/03/00491

Land rear of Resthaven, Foxhall Road, Southminster

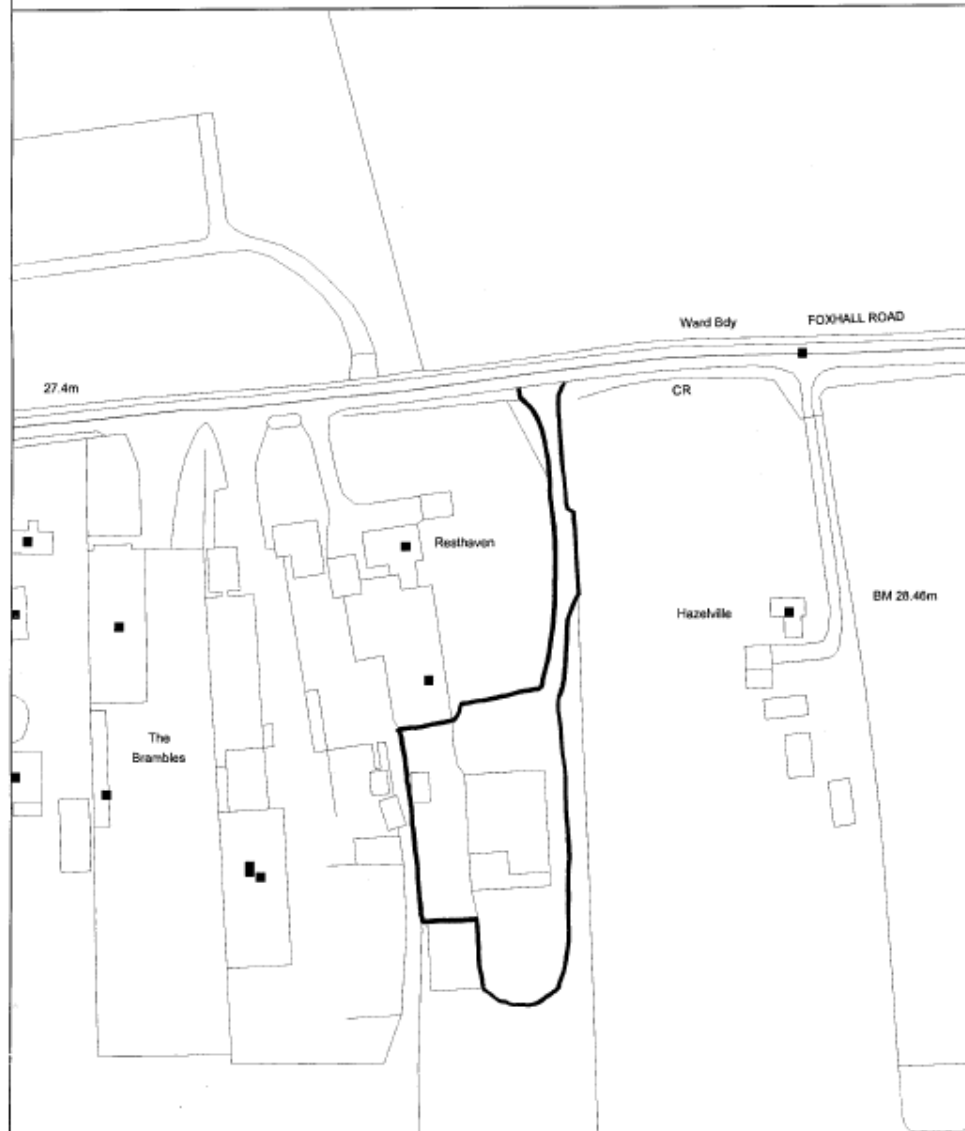

Copyright

This copy has been produced specifically for Map Return Scheme purposes only. No further copies may be made.

This map is reproduced from Ordnance Survey material with the permission of Ordnance Survey on behalf of the Controller of Her Majesty's Stationary Office © Crown copyright.

Scale:

1:1250

Organisation

Maldon District Council

Department

Development Control

Comments



MALDON DISTRICT COUNCIL

Princes Road, Maldon, Essex CM9 5DL
Telephone: 01621 854477

TOWN AND COUNTRY PLANNING ACT 1990

APPLICATION REFERENCE

FUL/MAL/20/00459

PROPOSAL

Change of use of land from agriculture to B8 storage and distribution and construction of storage building

LOCATION

Abaco House Foxhall Road Southminster Essex
(UPRN - 200000914147)

NAME OF APPLICANT:

Mr Peter Herrington

NAME AND ADDRESS OF AGENT:

Mr Anthony Cussen - Cussen
Construction Consultants
The Poplars
Mill End
Bradwell on Sea
CM0 7HJ

DECISION DATE 5 October 2020

In pursuance of the powers exercised by them as Local Planning Authority this Council having considered your application to carry out the above development in accordance with the submitted plans referenced 1177/01, 1177/02 A, 1177/03 B, 1177/04, do hereby give notice of their decision to:

GRANT PERMISSION

for the said development subject to compliance with the conditions appended to this Notice.



RICHARD HOLMES
DIRECTOR OF SERVICE DELIVERY

IMPORTANT: PLEASE REFER TO THE NOTES ATTACHED TO THIS DOCUMENT

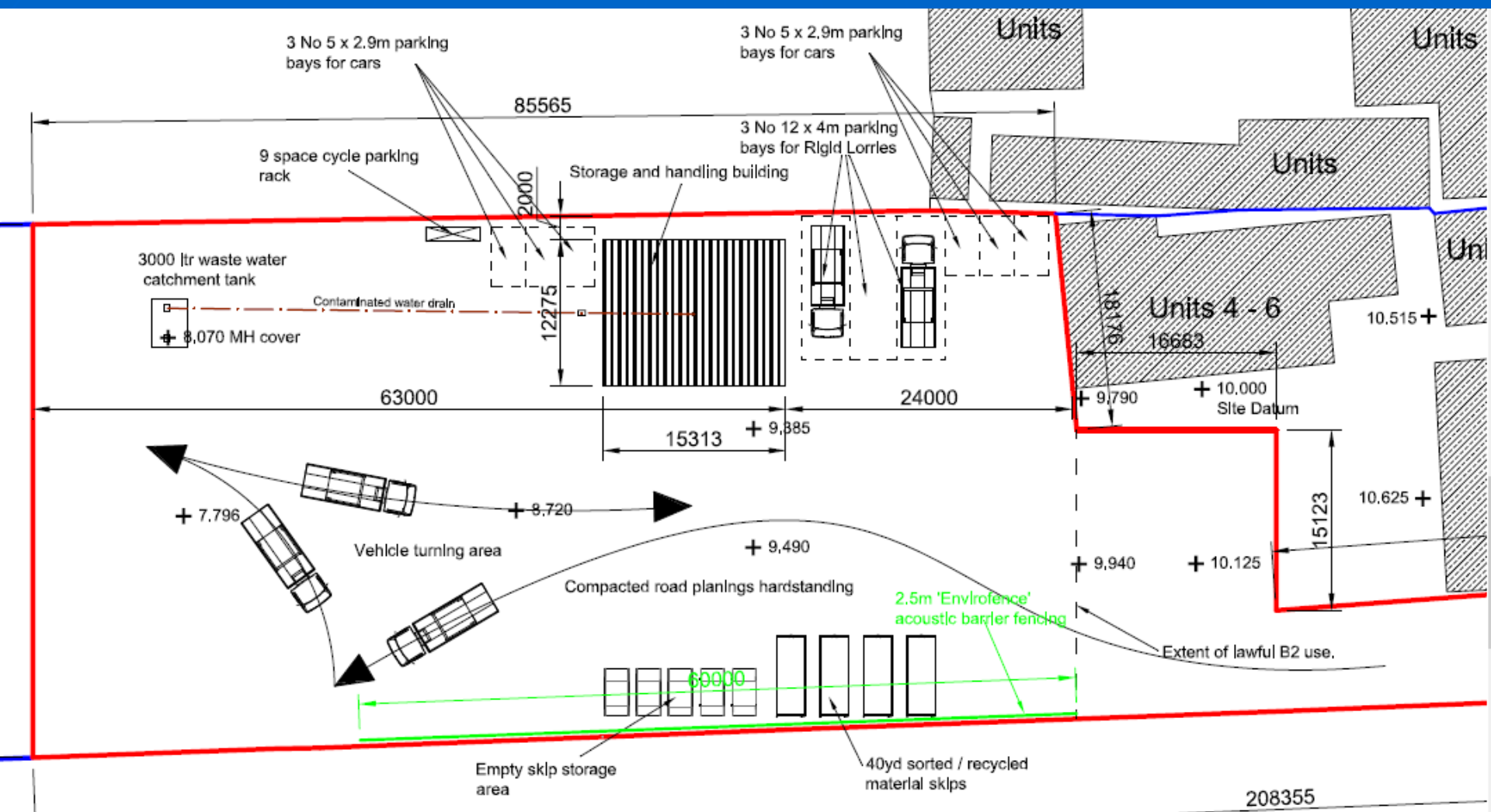

North







Visibility from entrance, looking east



Visibility from entrance, looking west

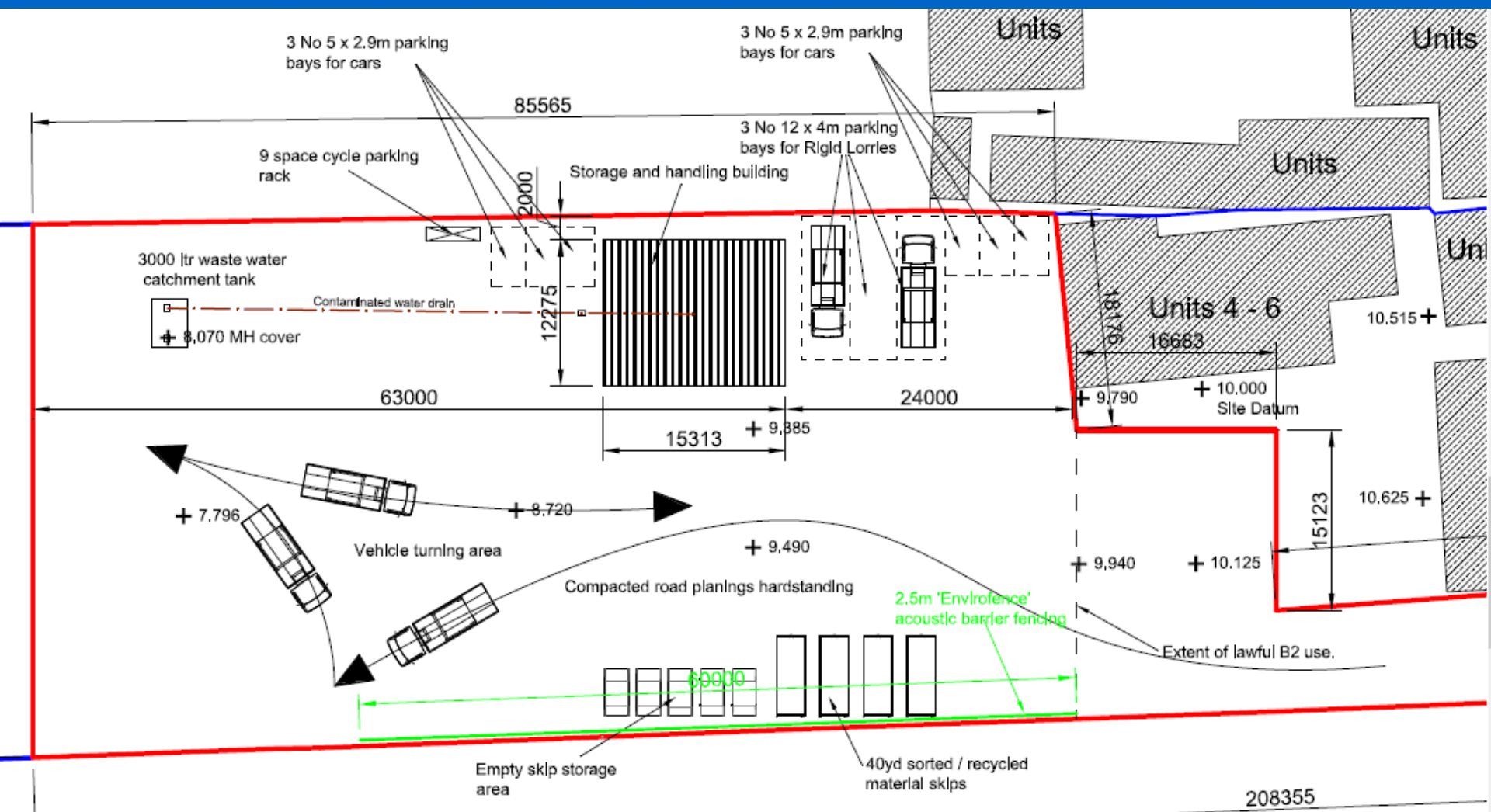

North



Pitsea Landfill, Pitsea, Basildon
ESS/49/14/BAS

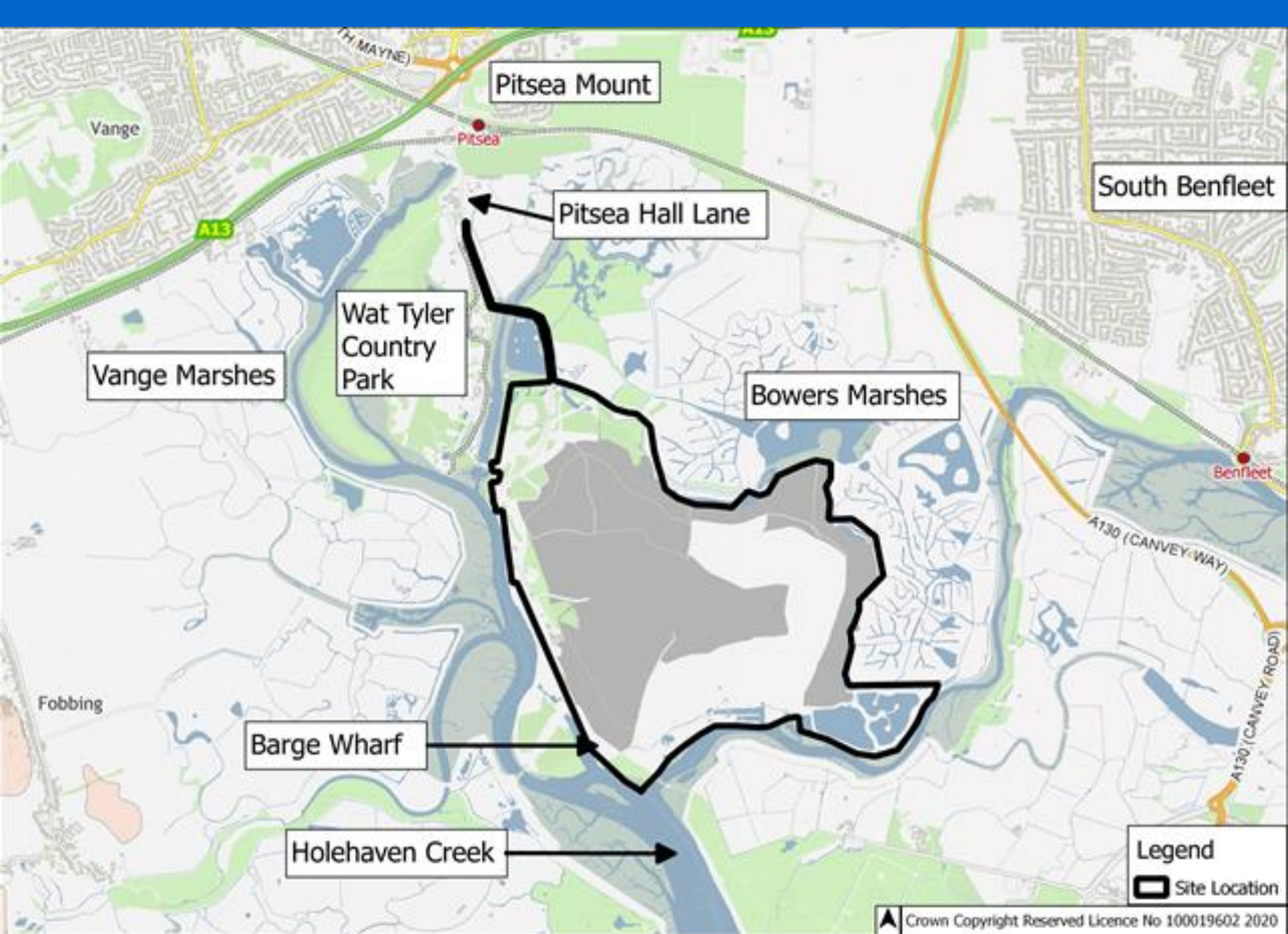









PROTECTION
SCHEME
LORRIES
Wait here until lorry in
is passed End of bridge
Keep to middle of road

Public Footpath

One Way



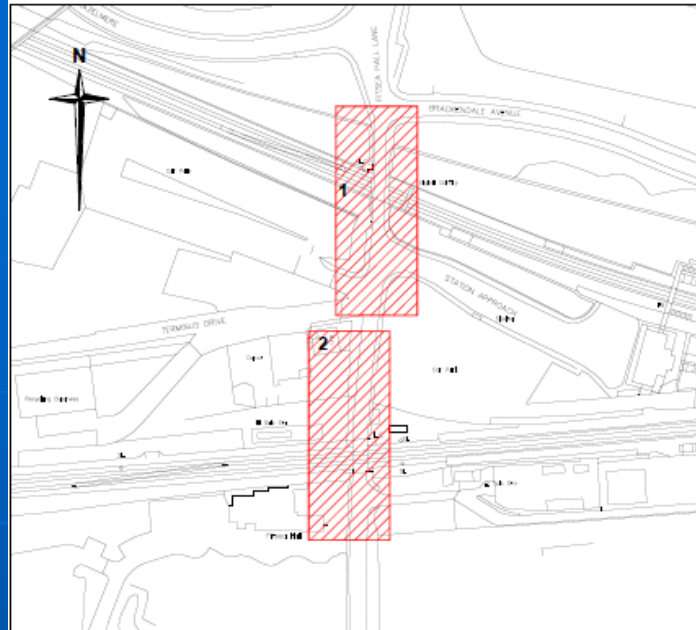

THRO' SECTION A-A NTS

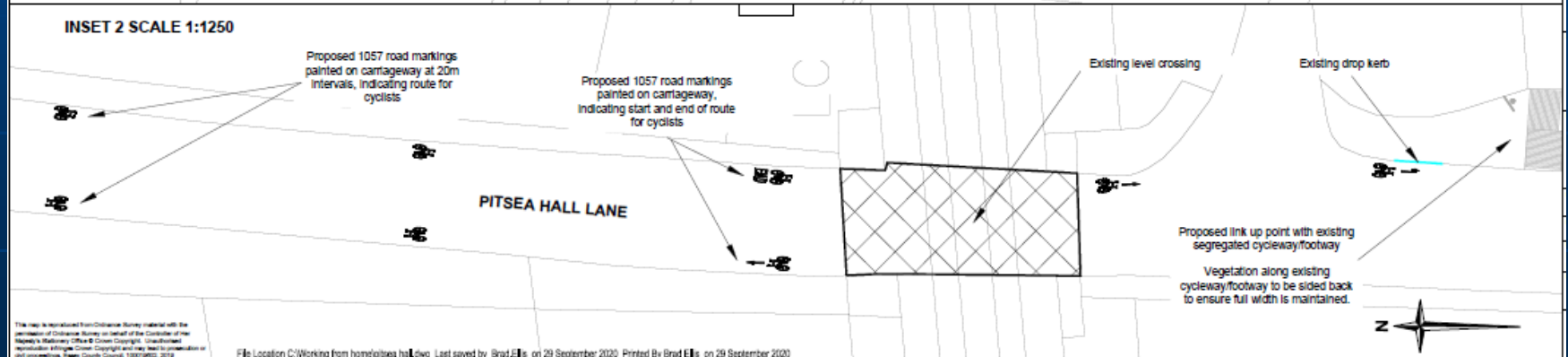
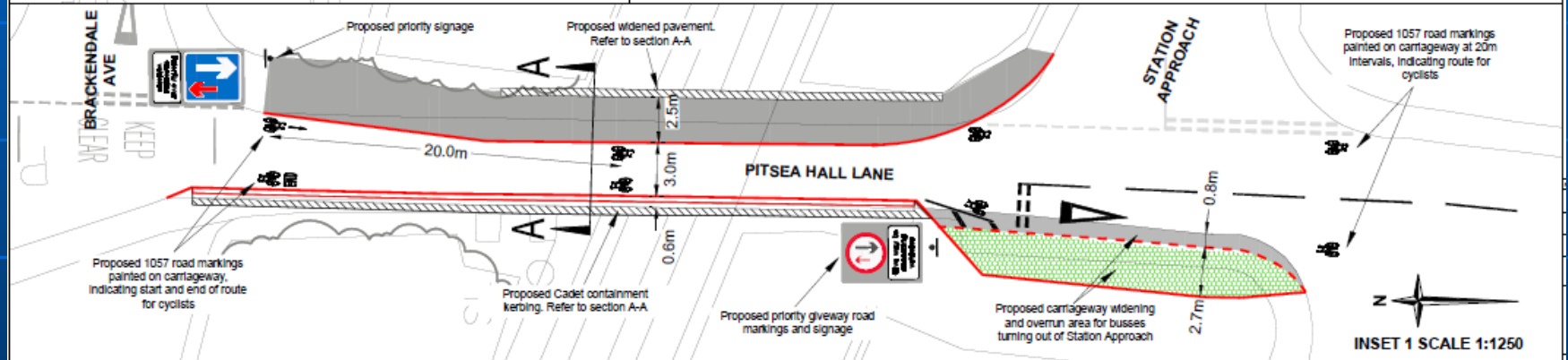
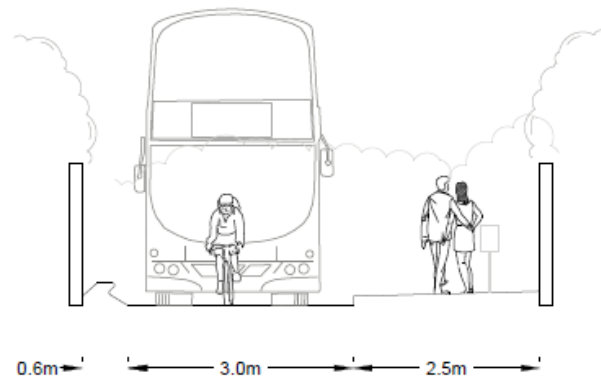

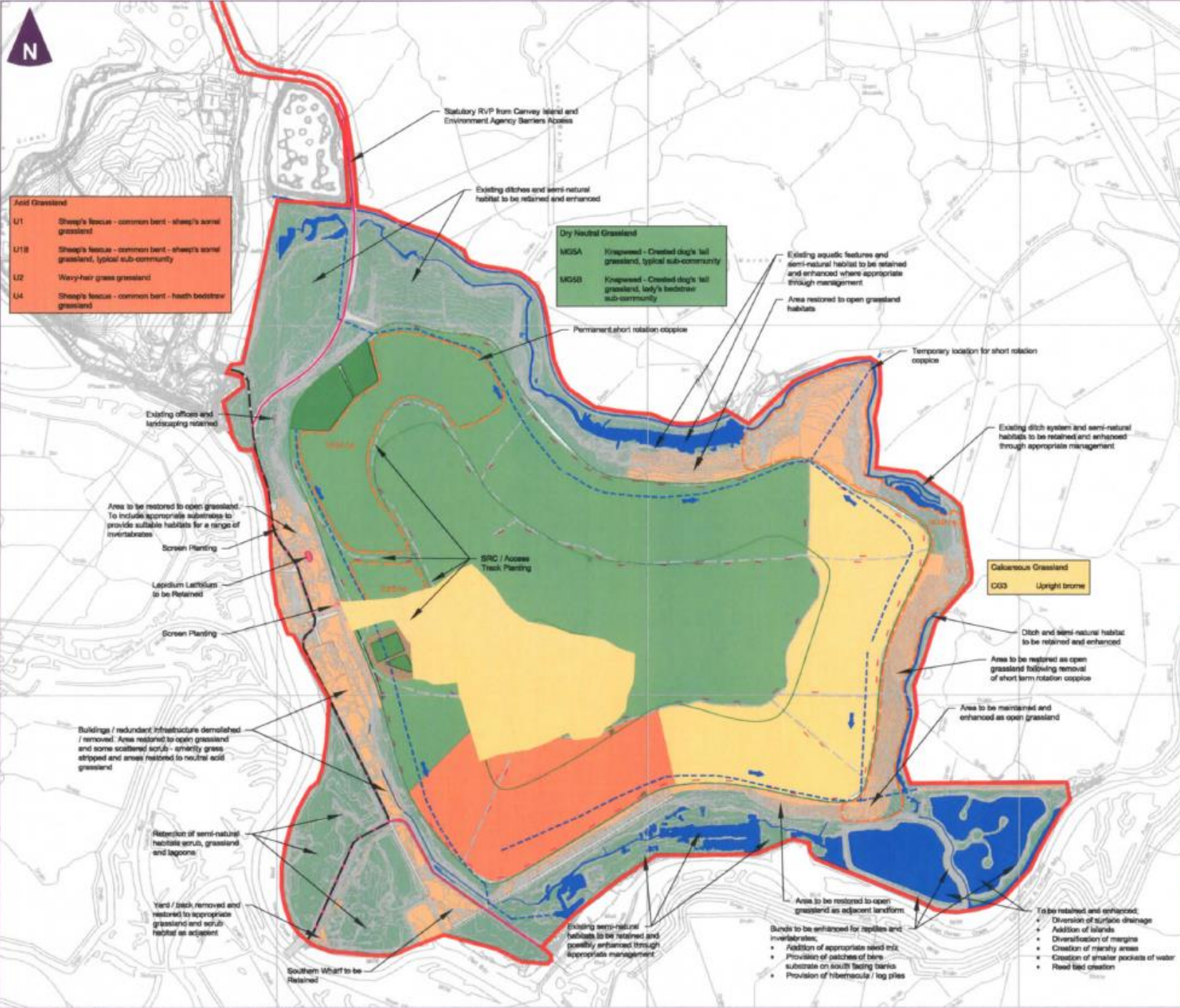

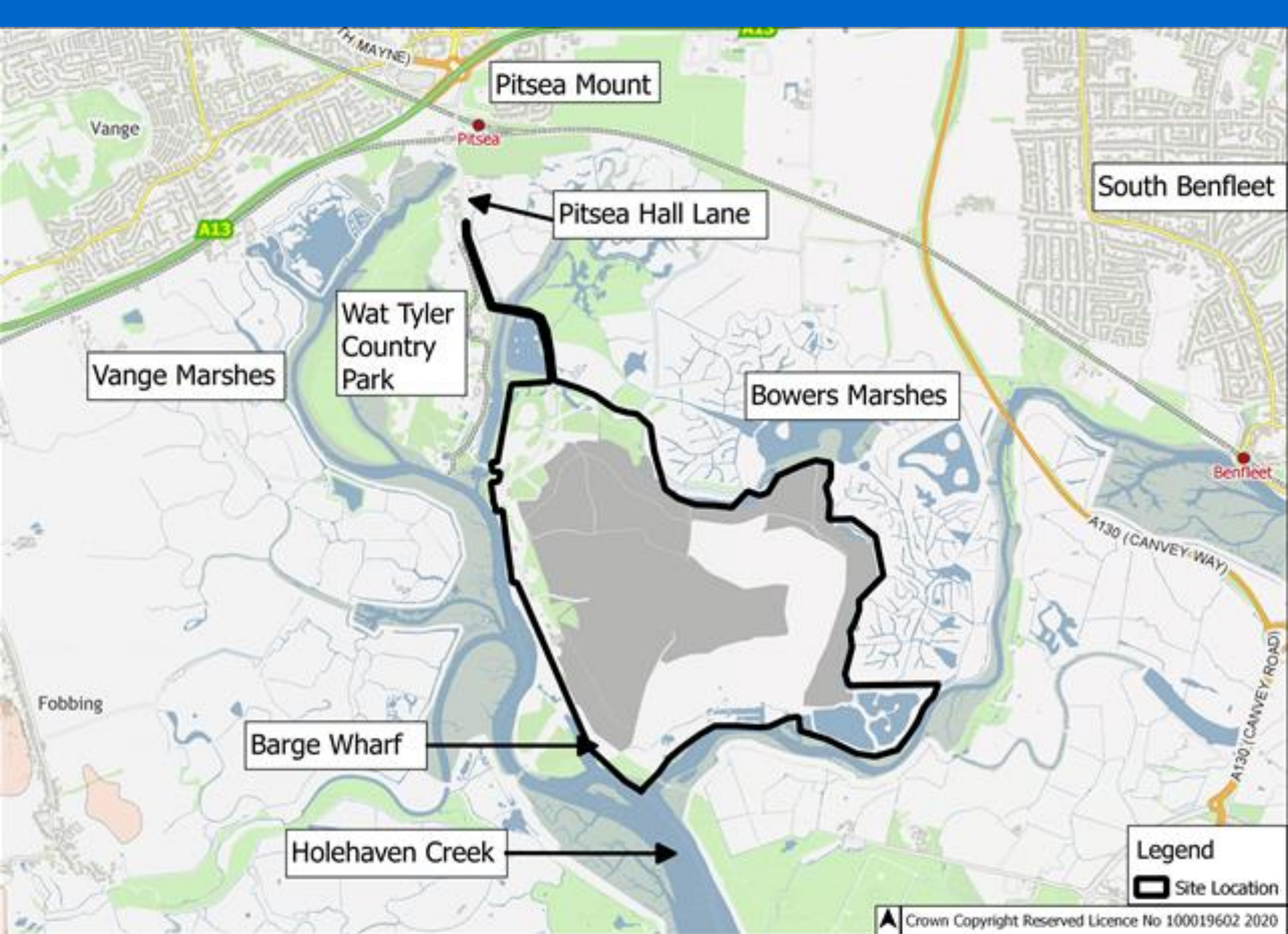



Development and Regulation Committee