

- Notes
1. Traffic signals at the junction of North Hill, High Street and Head Street shall include a cycles only phase to remove conflict with traffic using general traffic lanes.
- Key
- Proposed No Waiting At Any Time
  - Existing road markings to remain
  - Ramp from carriageway to footway level and vice versa.
  - Proposed southbound cycle lane
  - Proposed Northbound cycle lane
  - Permitted direction of travel for cyclists in cycle lanes as indicated by arrows.
  - Advisory direction of travel for cyclists on cycle track as indicated by arrows.
  - Permitted direction of travel for traffic using general traffic lane (to remain unchanged).
  - Area of cycle track to be created in carriageway, raised to existing footway level.
  - Existing footway to be converted to cycle track at existing footway level.
  - Segregation strip between cycle lanes/cycle track and carriageway.
  - Proposed No Stopping at Any Time Except Taxis.
  - Proposed Goods Vehicles Loading Only Mon-Sat 8am-6pm / No Stopping Except Taxis at other times.
  - Proposed Goods Vehicles Loading Only.
  - No waiting and no loading at any time

Rev.	Date	Description of revision	Drawn	Checked	Reviewed	Approved
F	JAN 23	Adjustments to DYL, no loading and no stopping restrictions	MC	PN	PN	LS
E	DEC 22	Added DYL adjacent to cycle track	MC	PN	PN	LS
D	NOV 22	Added cycle track measurement.	MC	PN	PN	LS

FOR INFORMATION



Essex Highways, Seax House, Victoria Road South, Chelmsford, CM1 1QH.  
Tel: 0345 6037631  
© Essex County Council

SCHEME TITLE

EATF2 COLCHESTER

DRAWING TITLE

PROPOSED TRAFFIC ORDERS AND AMENDMENTS  
HEAD STREET, COLCHESTER

DESIGNED	DRAWN	CHECKED	REVIEWED	APPROVED
IHJ	IHJ	CB	CB	LS
DATE	DATE	DATE	DATE	DATE
JULY 22	JULY 22	AUG 22	AUG 22	AUG 22
DRAWING UNITS U.N.O.			SCALE AT A3 (420x297mm)	
DIMENSIONS IN METRES			1:500	
DRAWING No.				REV.
ATF-COL-TRO2				F





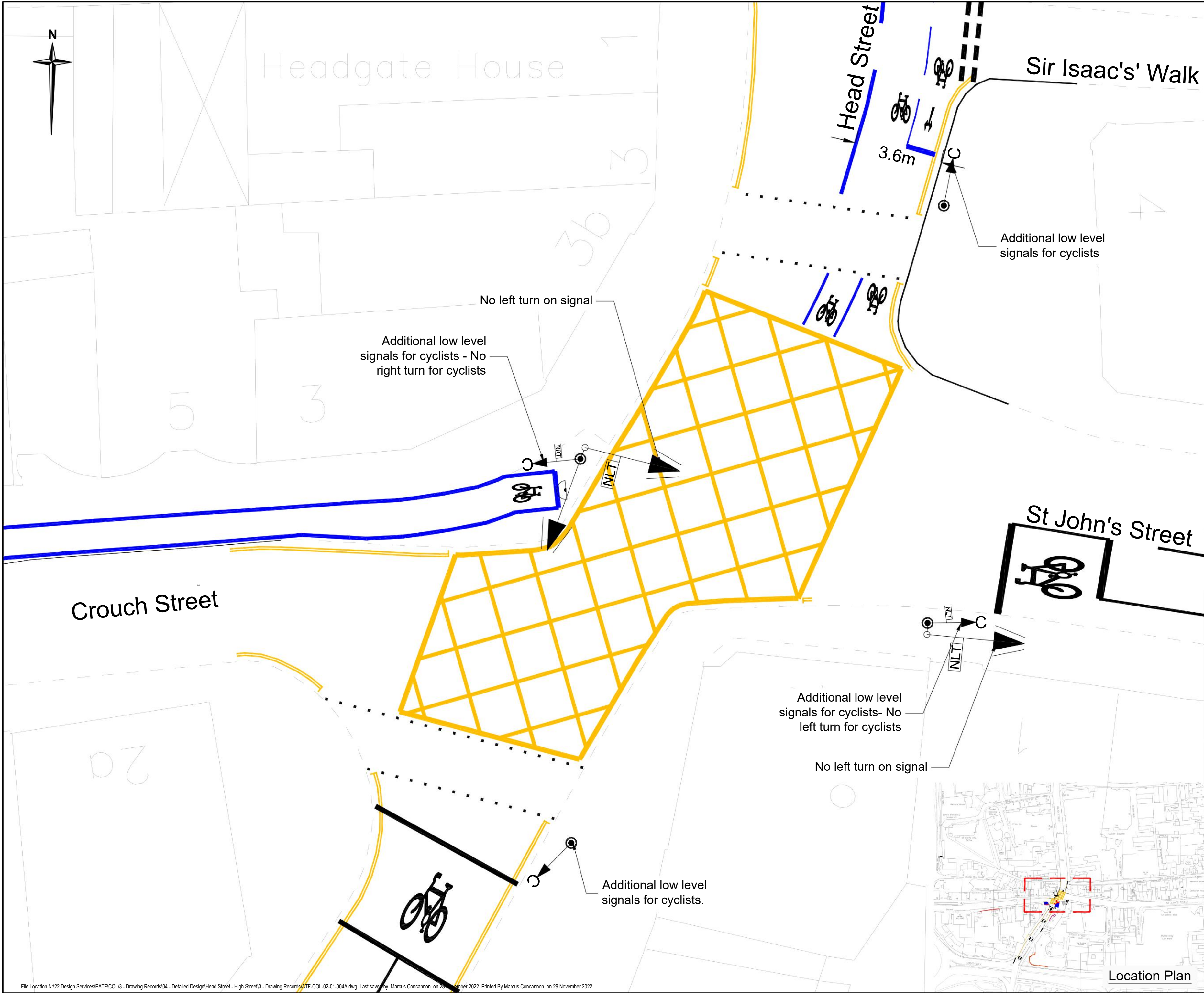

- Key
- Area of interest
  - CYCLE SYMBOL IN WHITE THERMOPLASTIC SCREED TO TSRGD DIAG 1057, 750mm WIDE.
  - Road Markings in White Thermoplastic Screed
  - New Items
  - Traffic Signal Post with Cycle Signal Head

This map is reproduced from Ordnance Survey material with the permission of Ordnance Survey on behalf of the Controller of His Majesty's Stationery Office © Crown Copyright. Unauthorised reproduction infringes Crown Copyright and may lead to prosecution or civil proceedings. Essex County Council, 100019602, 2022

Rev.	Date	Description of revision	Drawn	Checked	Reviewed	Approved
A	11/22	Minor amendments	MC	PN	PN	LS

DRAWING STATUS

For Consultation



Essex Highways, Seax House, Victoria Road South, Chelmsford, CM1 1QH.  
Tel: 0345 6037631  
© Essex County Council

SCHEME TITLE

ACTIVE TRAVEL FUND (ATF2), HEADGATE JUNCTION WITH ST JOHN'S STREET AND CROUCH STREET, COLCHESTER

DRAWING TITLE

TRO PLAN  
PROPOSED RIGHT TURN  
PROHIBITION FROM CROUCH STREET CYCLEWAY

DESIGNED	DRAWN	CHECKED	REVIEWED	APPROVED
CM	CM	ADF		LS
DATE	DATE	DATE	DATE	DATE
Jan 22	Jan 22	Jan 22		Jan 22

DRAWING UNITS U.N.O. DIMENSIONS IN MILLIMETRES LEVELS IN METRES

SCALE AT A2 (594x420mm) NTS

DRAWING No. ATF-COL-TRO4

REV. A





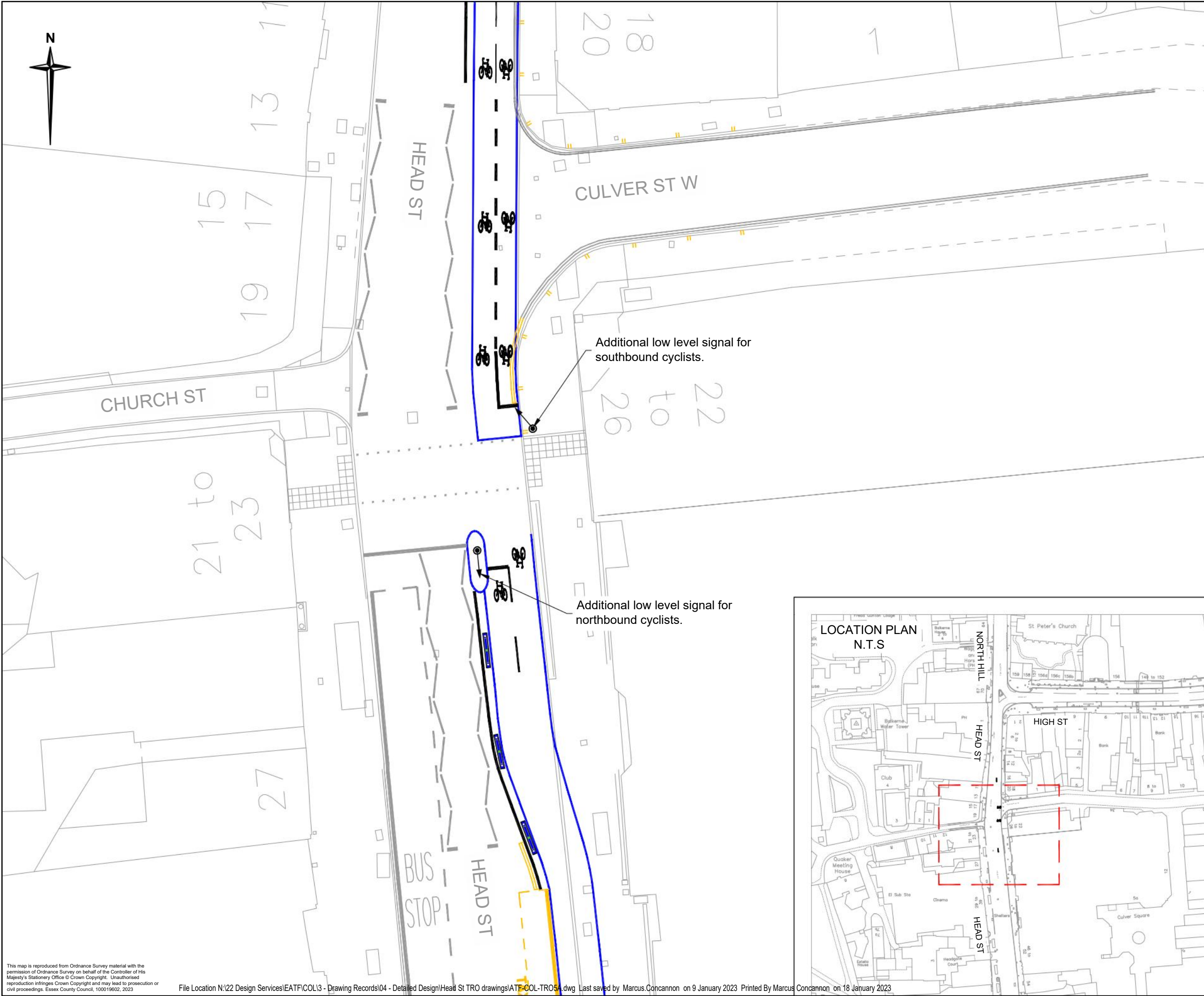

Notes

1. Do not scale.

Key

- Area of interest
- New Road markings in white
- New Road markings in yellow
- Traffic Signal Post with Cycle Signal Head
- New Facilities

Rev.	Date	Description of revision	Drawn	Checked	Reviewed	Approved
A	JAN 23	Adjustments to DYL	MC	PN	PN	LS

FOR INFORMATION

**Essex Highways**

Essex Highways, Seax House, Victoria Road South, Chelmsford, CM1 1QH.  
Tel: 0345 6037631  
© Essex County Council

**ACTIVE TRAVEL FUND (ATF)  
HEAD ST  
COLCHESTER**

DRAWING TITLE

**CULVER ST W CROSSING  
TRO PLAN**

DESIGNED	DRAWN	CHECKED	REVIEWED	APPROVED
MC	MC	PN	PN	LS
DATE	DATE	DATE	DATE	DATE
NOV 22	NOV 22	NOV 22	NOV 22	NOV 22

DRAWING UNITS U.N.O.	SCALE AT A3 (420x297mm)
DIMENSIONS IN MILLIMETRES	1:200
LEVELS IN METRES	

DRAWING No.	REV.
<b>ATF-COL-TRO5</b>	<b>A</b>

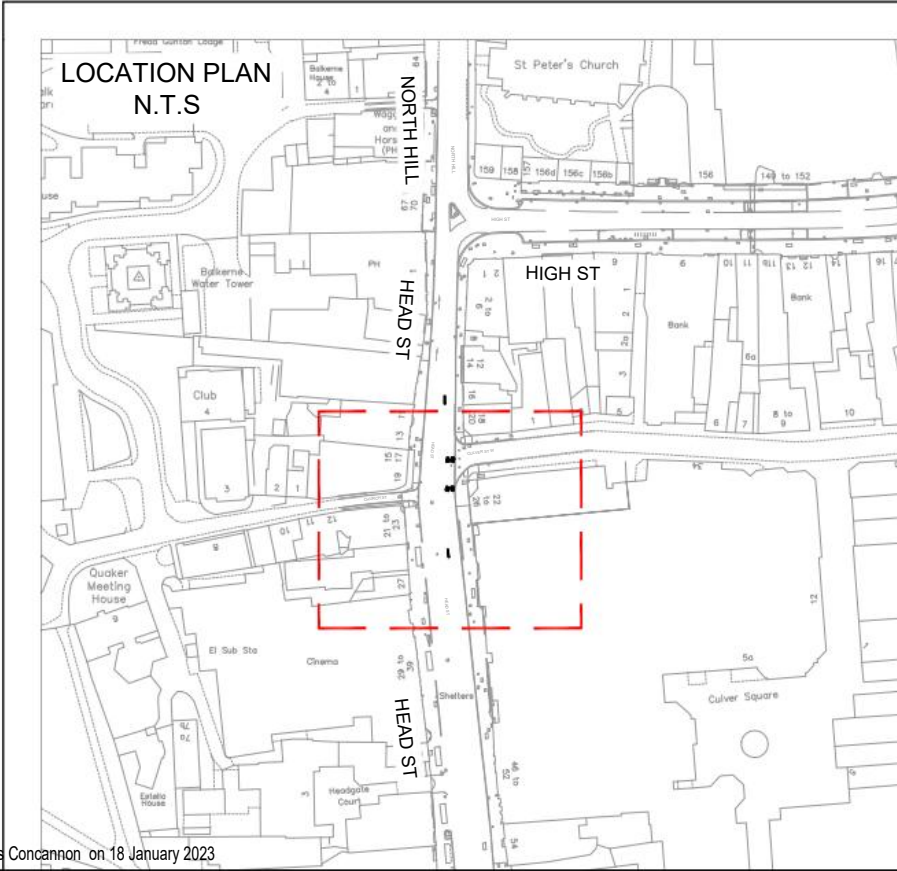

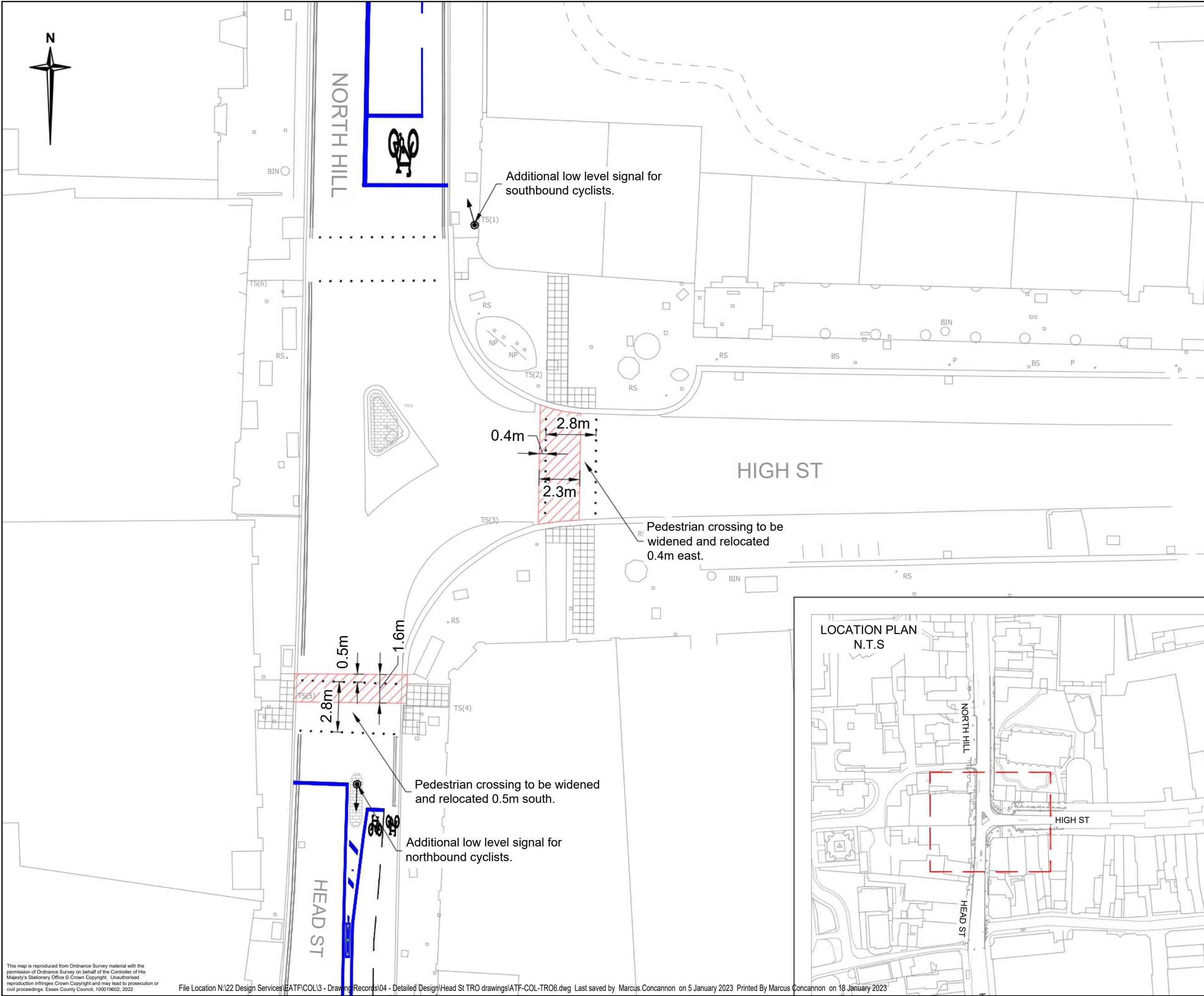

Notes

1. Do not scale.

Key

Area of interest

New Road markings in white

New Road markings in yellow

Traffic Signal Post with Cycle Signal Head

New Facilities

Existing pedestrian crossing location

Rev.	Date	Description of revision	Drawn	Checked	Reviewed	Approved

DRAWING STATUS

FOR INFORMATION

Essex

Highways

Essex Highways, Seax House, Victoria Road South,  
Chelmsford, CM1 1QH.  
Tel: 0345 6037631

© Essex County Council

SCHEME TITLE

ACTIVE TRAVEL FUND (ATF)  
HEAD ST  
COLCHESTER

DRAWING TITLE

HEAD ST - HIGH ST CROSSING  
TRO PLAN

DESIGNED	DRAWN	CHECKED	REVIEWED	APPROVED
MC	MC	PN	PN	LS
DATE	DATE	DATE	DATE	DATE
NOV 22	NOV 22	JAN 23	JAN 23	JAN 23
DRAWING UNITS U.N.O.				SCALE AT A3 (420x297mm)
DIMENSIONS IN MILLIMETRES				1:200
LEVELS IN METRES				

DRAWING No.

ATF-COL-TRO5

REV.

-

RINGWAY

JACOBS

integrated expertise

Essex County Council