

DR/54/13

committee DEVELOPMENT & REGULATION

date 22 November 2013

MINERALS AND WASTE DEVELOPMENT INFORMATION ITEM - ENFORCEMENT OF PLANNING CONTROL

The unauthorised extraction and exportation of sand and gravel from the land and the importation and deposition of waste materials and consequential raising of the land levels (the unauthorised development).

Location: Land at Dairy House Farm, Little Clacton Road, Great Holland. CO13 0EX

Report by Director for Operations, Environment and Economy

Enquiries to: Suzanne Armstrong 01245437556

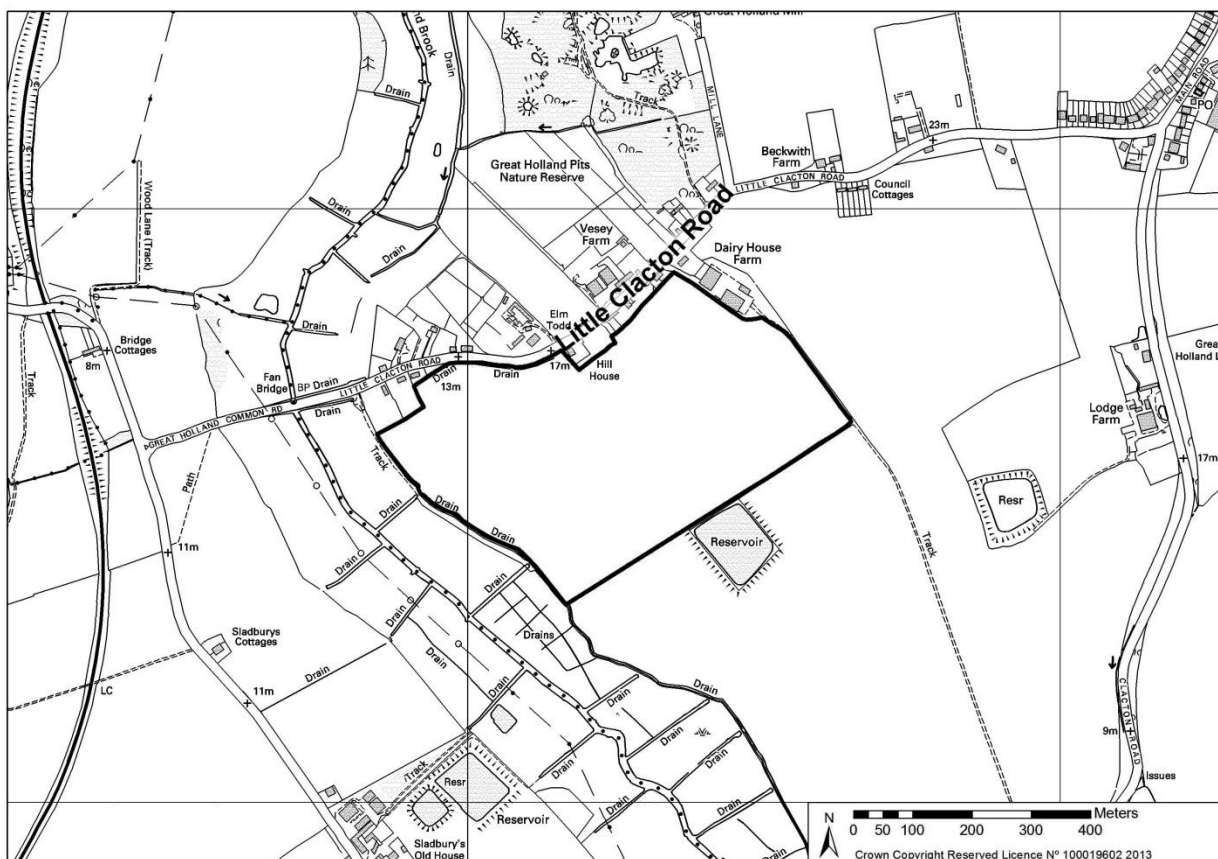

Reproduced from the Ordnance Survey Map with the permission of the Controller of Her Majesty's Stationery Office, Crown Copyright reserved Essex County Council, Chelmsford Licence L000 19602

1. BACKGROUND AND SITE

A report was presented to the Committee on the 25 October 2013 providing an update on enforcement matters relating to the above site. At that meeting the committee resolved:

- 1) Subject to no further extraction and exportation of mineral taking place and that the land is restored, no further action is taken.
- 2) A further update shall be provided at the November meeting.

On the 31 July 2013 the Waste Planning Authority (WPA) became aware of alleged unauthorised mineral extraction taking place on the land.

On the 7 August 2013 the WPA issued a Temporary Stop Notice alleging that there had been a breach of planning control relating to the unauthorised extraction and exportation of sand and gravel from the land and the importation and deposition of waste materials, and consequential raising the land levels (the unauthorised development)

The landowner was required to cease all activities.

The notice took effect on the 7th August 2013 and remained in force for 28 days.

The land owner immediately ceased all activities on the land

Dairy House farm is located near the village of Great Holland, approximately 3 miles North East of Clacton-On-Sea. The site is located within the Countryside. Dairy House Farm consists of an agricultural property with a group of farm buildings.

The landowner's primary business is agriculture.

The extraction of sand and gravel with associated infilling with waste materials is considered an additional operation outside permitted agricultural use.

On witnessing the extraction of sand and gravel with associated infilling it was considered that unauthorised mineral working can cause serious harm including damage to the amenity and harm to the landscape character of an area which can be caused and become irreparable very quickly.

2. CURRENT POSITION

Since serving the Temporary Stop Notice the landowner has ceased the unauthorised activities on the land. The Temporary Stop Notice expired on the 5 September 2013.

No further mineral extraction or exportation has taken place. Remedial works have been completed. The land owner has restored the land to its former agricultural

use and the field has been returned to an acceptable condition.

LOCAL MEMBER NOTIFICATION

TENDRING – Frinton and Walton