

SCALE 1:2500

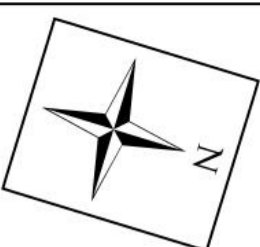

The Avenue

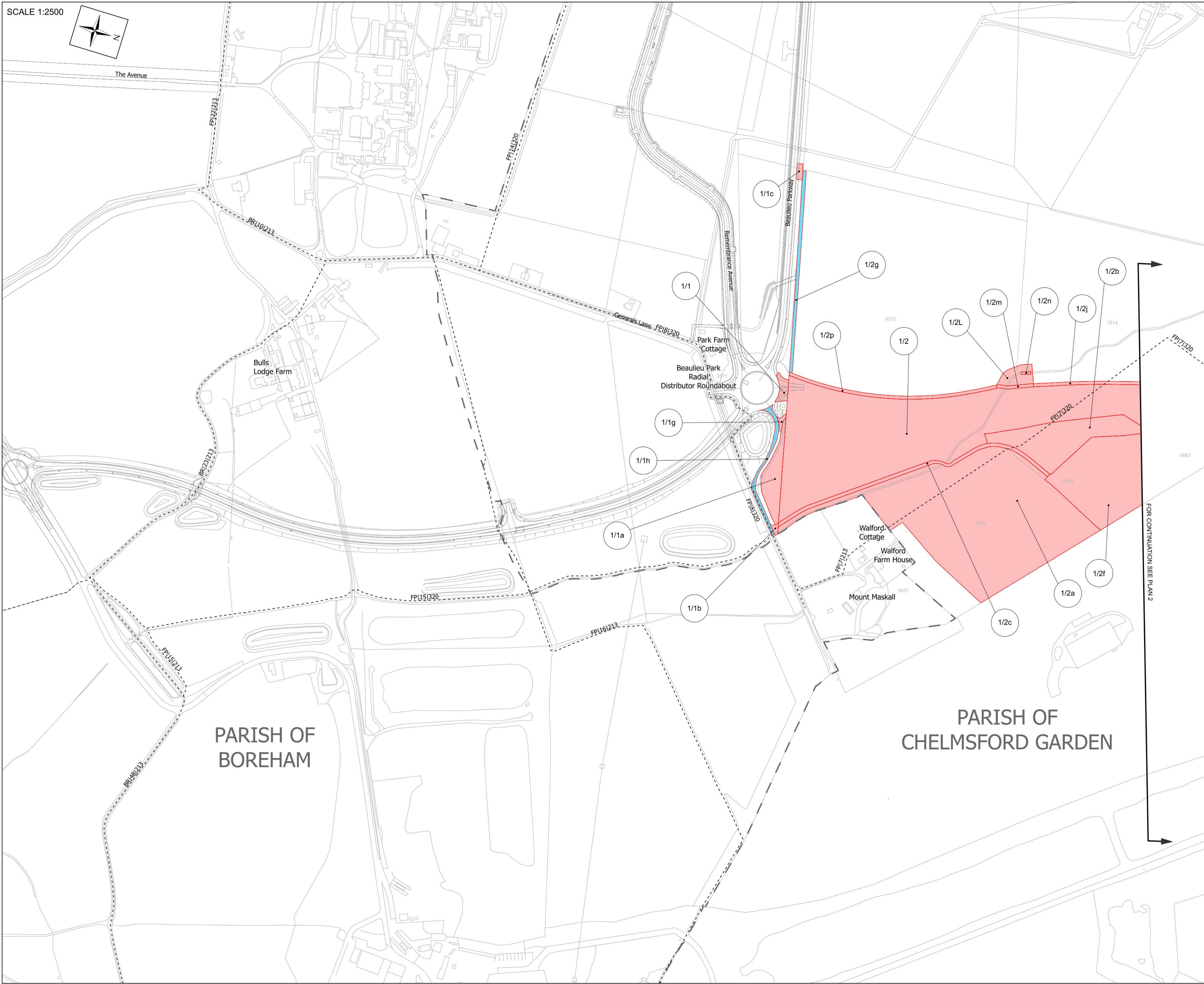

LOCATION PLAN

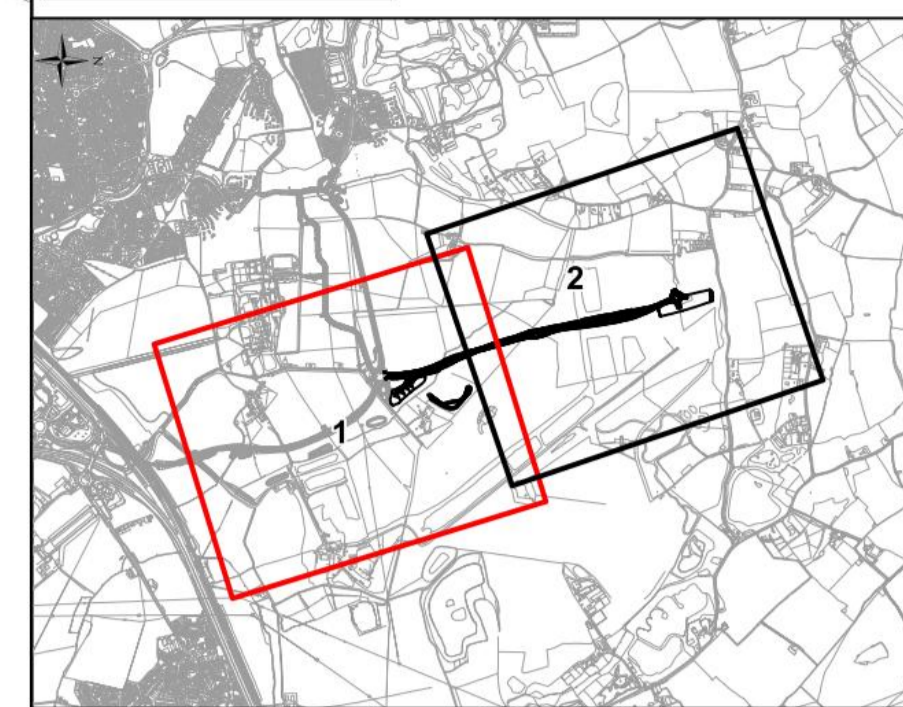

KEY:

- Title
- Easement (S250 right)
- Public right of way
- Parish boundary

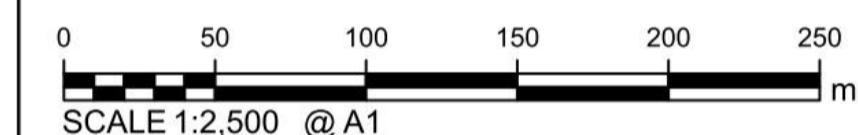

This map is reproduced from Ordnance Survey materials with the permission of Ordnance Survey on behalf of the Controller of Her Majesty's Stationery Office. © Crown Copyright and database rights 2024 OS 100019602. Unauthorised reproduction infringes Crown Copyright and may lead to prosecution or civil proceedings. Essex County Council

FOR CONTINUATION SEE PLAN 2

THE COMMON SEAL OF
ESSEX COUNTY COUNCIL
was hereunto affixed
in the presence of

.....
Attesting Officer

Dated this day of 2024



THE ESSEX COUNTY COUNCIL
(CHELMSFORD NORTH EAST BYPASS)
(PHASE 1A)
COMPULSORY PURCHASE ORDER 2024

COMPULSORY PURCHASE
ORDER MAP
MAP 1 OF 2

PARISH OF BOREHAM

PARISH OF CHELMSFORD GARDEN