

**SCALE** 1:10,000

**KEY:**  
 Sheet layout

0

200

400

600

800

1,000

m

**SCALE** 1:10,000@ A1

This map is reproduced from Ordnance Survey material with the permission of Ordnance Survey on behalf of the Controller of Her Majesty's Stationery Office © Crown Copyright and database right 2019. OS 100030646. Unauthorised reproduction infringes Crown Copyright and may lead to prosecution or civil proceedings. Highways England.

Rev	Date	Description of revision	Drawn	Checked	Reviewed	Approved
R0	11/02/20	FIRST REVISION	RJ	ME	RT	GI
R1	11/09/20	REVISED FROM LEGAL REVIEW	RJ	ME	RT	GI
R2	11/11/20	REVISED FROM LEGAL REVIEW	RJ	ME	RT	GI

DRAWING STATUS

**CONSULTATION**

**Essex**  
Highways

Essex Highways, Seax House, Victoria Road South,  
Chelmsford, CM1 1QH.  
Tel: 0345 6037631

© Essex County Council

SCHEME TITLE

**A127 FAIRGLEN INTERCHANGE**

DRAWING TITLE

**SHEET PLAN**

DESIGNED	DRAWN	CHECKED	REVIEWED	APPROVED
--	RJ	ME	RT	GI
DATE	DATE	DATE	DATE	DATE
--	NOV 20	NOV 20	NOV 20	NOV 20

SCALE (AT A1)

1:10,000

DO NOT SCALE

DRAWING No:  
**B3553T26\_Land\_Reference\_Key\_Plan**

REV  
**R2**

**RINGWAY**  
JACOBS  
integrated expertise

**Essex County Council**



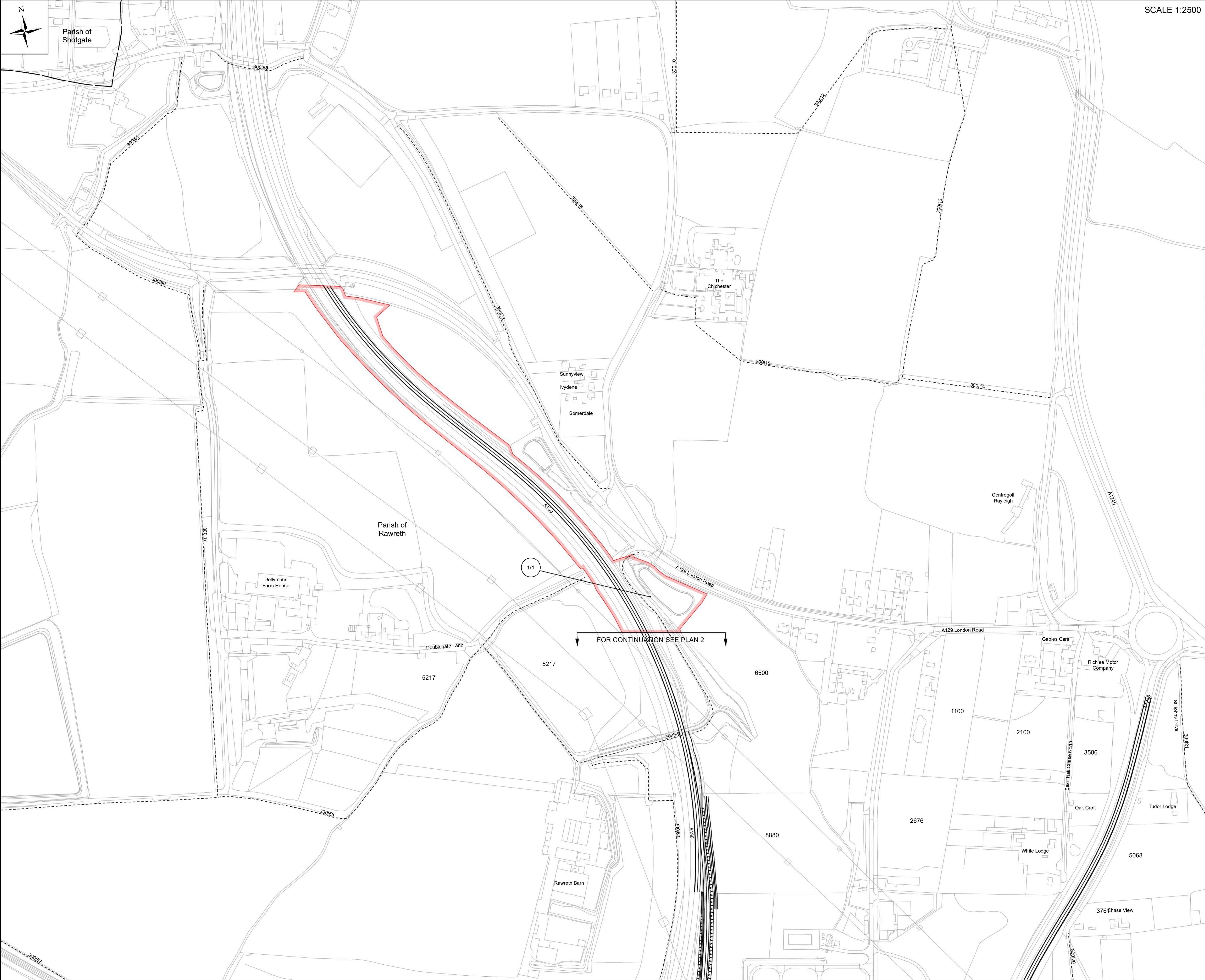

SCALE 1:2500

**LOCATION PLAN**

**KEY:**

- Title
- Title mitigation
- Easement (S250 right)
- Essential licence
- Title (private means of access)
- Licence (private means of access)
- Land in ownership of Acquiring Authority
- Parish boundary
- Public right of way

0 50 100 150 200 250 m

SCALE 1:2,500 @ A1

This map is reproduced from Ordnance Survey material with the permission of Ordnance Survey on behalf of the Controller of Her Majesty's Stationary Office. Crown Copyright and Database rights 2019. OS 100032046. Unauthorised reproduction infringes Crown Copyright and may lead to prosecution or civil proceedings. Highways England.

Rev	Date	Description of revision	Drawn	Checked	Reviewed	Approved
R0	11/02/20	FIRST REVISION	RJ	ME	RT	GI
R1	11/09/20	REVISED FROM LEGAL REVIEW	RJ	ME	RT	GI
R2	11/11/20	REVISED FROM LEGAL REVIEW	RJ	ME	RT	GI

DRAWING STATUS

**CONSULTATION**

**Essex Highways**

Essex Highways, Seax House, Victoria Road South, Chelmsford, CM1 1QH.  
Tel: 0345 6037631 © Essex County Council

SCHEME TITLE

**A127 FAIRGLEN INTERCHANGE**

DRAWING TITLE

**LAND REFERENCE PLAN**

**SITE PLAN 1 OF 6**

DESIGNED	DRAWN	CHECKED	REVIEWED	APPROVED
SR	RJ	ME	RT	GI
DATE	DATE	DATE	DATE	DATE
NOV 20	NOV 20	NOV 20	NOV 20	NOV 20

SCALE (AT A1)

1:2,500

DO NOT SCALE

DRAWING No. **B3553T26\_Land\_Reference\_Plan\_Sheet\_1**

REV. **R2**

**RINGWAY JACOBS**  
integrated expertise

**Essex County Council**





**LOCATION PLAN**

**KEY:**

- Title
- Title mitigation
- Easement (S250 right)
- Essential licence
- Title (private means of access)
- Licence (private means of access)
- Land in ownership of Acquiring Authority
- Parish boundary
- Public right of way

0 50 100 150 200 250 m

SCALE 1:2,500 @ A1

This map is reproduced from Ordnance Survey material with the permission of Ordnance Survey on behalf of the Controller of Her Majesty's Stationary Office. Crown Copyright and Database right 2019. OS 100030646. Unauthorised reproduction infringes Crown Copyright and may lead to prosecution or civil proceedings. Highways England.

Rev	Date	Description of revision	Drawn	Checked	Reviewed	Approved
R0	11/02/20	FIRST REVISION	RJ	ME	RT	GI
R1	11/09/20	REVISED FROM LEGAL REVIEW	RJ	ME	RT	GI
R2	11/11/20	REVISED FROM LEGAL REVIEW	RJ	ME	RT	GI

DRAWING STATUS

**CONSULTATION**

**Essex Highways**

Essex Highways, Seax House, Victoria Road South, Chelmsford, CM1 1QH.  
Tel: 0345 6037631 © Essex County Council

SCHEME TITLE

**A127 FAIRGLEN INTERCHANGE**

DRAWING TITLE

**LAND REFERENCE PLAN**

**SITE PLAN 2 OF 6**

DESIGNED	DRAWN	CHECKED	REVIEWED	APPROVED
SR	RJ	ME	RT	GI
DATE	DATE	DATE	DATE	DATE
NOV 20	NOV 20	NOV 20	NOV 20	NOV 20

SCALE (AT A1) 1:2,500 DO NOT SCALE

DRAWING No. **B3553T26\_Land\_Reference\_Plan\_Sheet\_2** REV. **R2**

**RINGWAY JACOBS** integrated expertise

**Essex County Council**



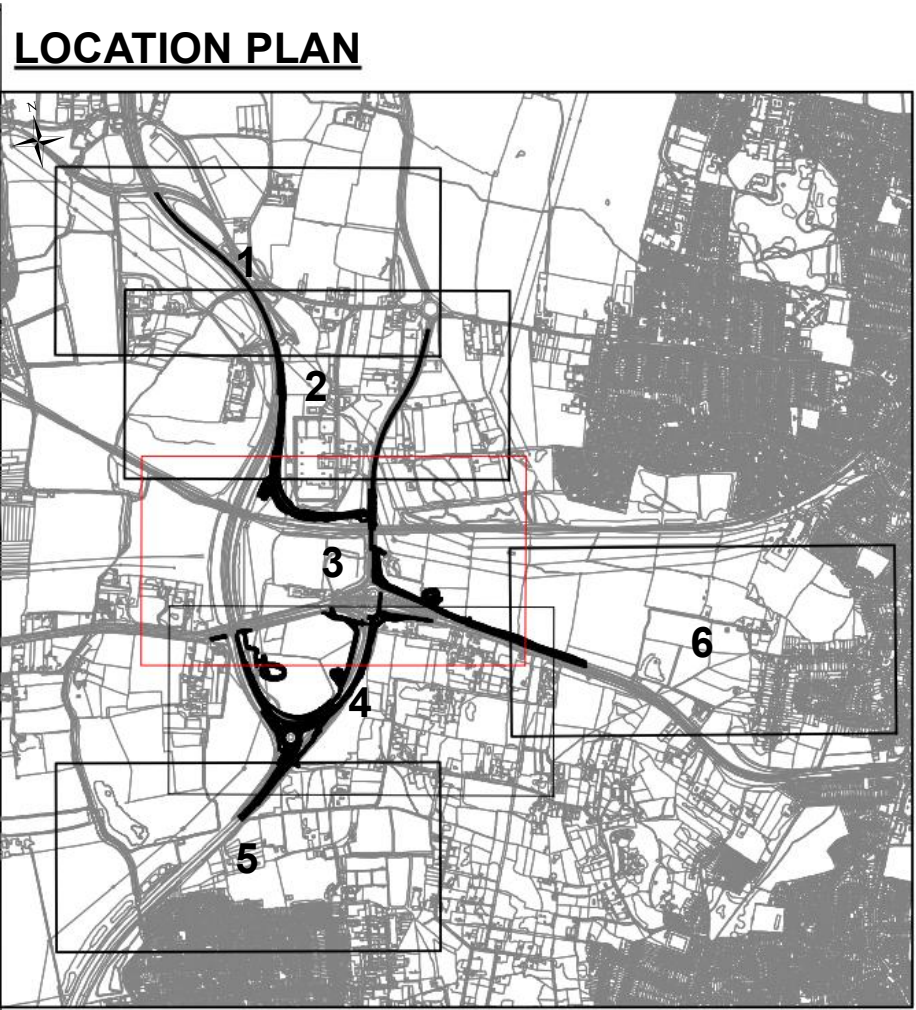

**KEY:**

[Red box]	Title
[Red box with diagonal lines]	Title mitigation
[Blue box]	Easement (S250 right)
[Green box with diagonal lines]	Essential licence
[Purple box]	Title (private means of access)
[Orange box]	Licence (private means of access)
[Pink box]	Land in ownership of Acquiring Authority
[Dashed line]	Parish boundary
[Dotted line]	Public right of way

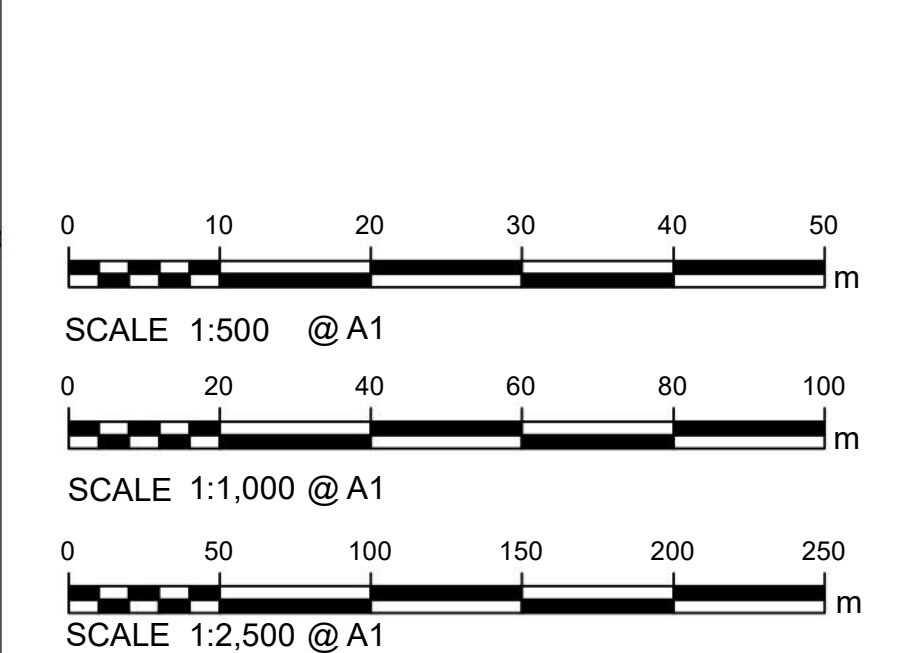

This map is reproduced from Ordnance Survey material with the permission of Ordnance Survey on behalf of the Controller of Her Majesty's Stationery Office. Crown Copyright and database right 2019. OS 100030646. Unauthorised reproduction infringes Crown Copyright and may lead to prosecution or civil proceedings. Highways England

Rev	Date	Description of revision	Drawn	Checked	Reviewed	Approved
R0	11/02/20	FIRST REVISION	RJ	ME	RT	GI
R1	11/09/20	REVISED FROM LEGAL REVIEW	RJ	ME	RT	GI
R2	11/11/20	REVISED FROM LEGAL REVIEW	RJ	ME	RT	GI

DRAWING STATUS

**CONSULTATION**

**Essex Highways**

Essex Highways, Seax House, Victoria Road South, Chelmsford, CM1 1QH.  
Tel: 0345 6037631

© Essex County Council

**A127 FAIRGLEN INTERCHANGE**

DRAWING TITLE

**LAND REFERENCE PLAN**

**SITE PLAN 3 OF 6**

DESIGNED	DRAWN	CHECKED	REVIEWED	APPROVED
SR	RJ	ME	RT	GI
DATE	DATE	DATE	DATE	DATE
NOV 20	NOV 20	NOV 20	NOV 20	NOV 20

SCALE (AT A1)

1:2,500

DO NOT SCALE

DRAWING No.	REV
B3553T26_Land_Reference_Plan_Sheet_3	R2

**RINGWAY JACOBS**  
integrated expertise

**Essex County Council**



Inset A - Scale 1:500

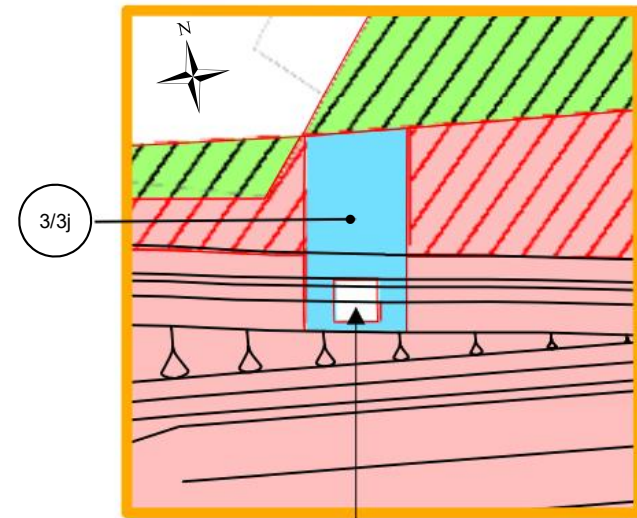

Inset B - Scale 1:500

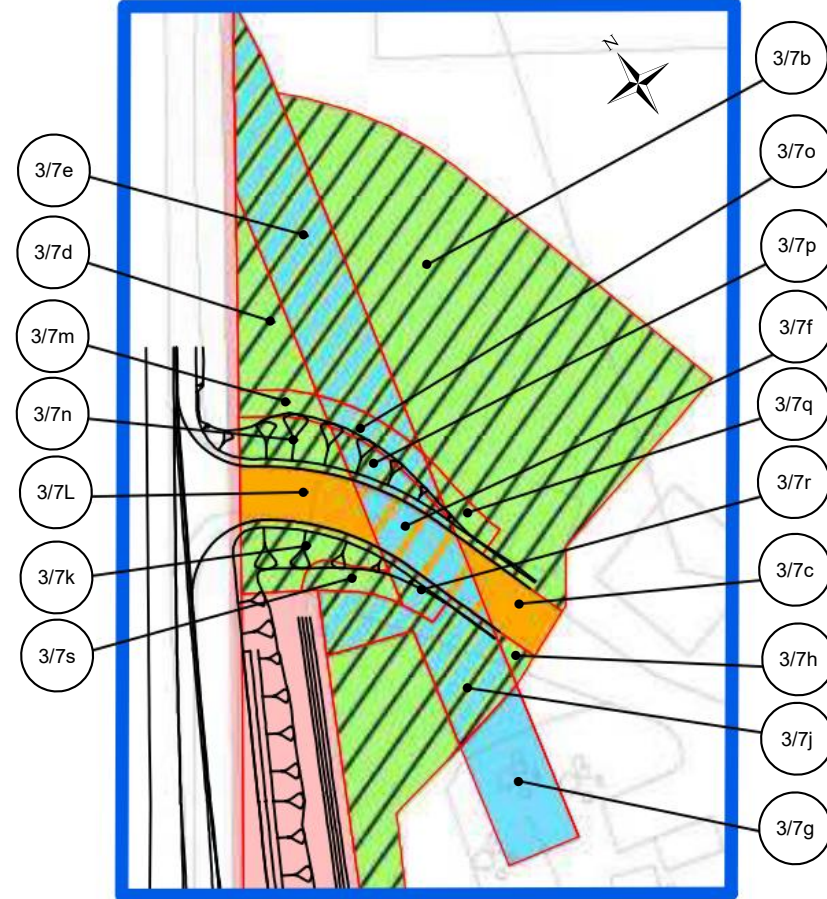

Inset C - Scale 1:1000

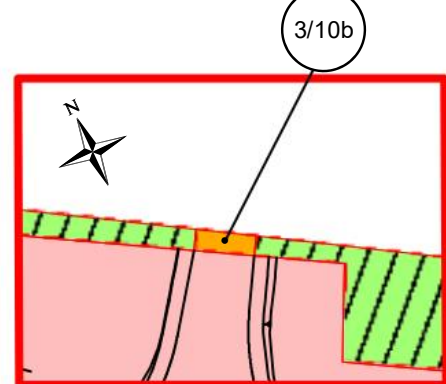

Inset D - Scale 1:500

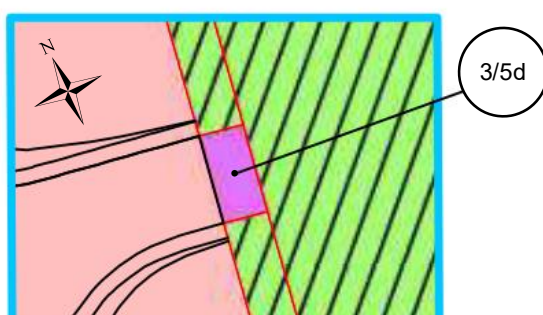

Inset E - Scale 1:500







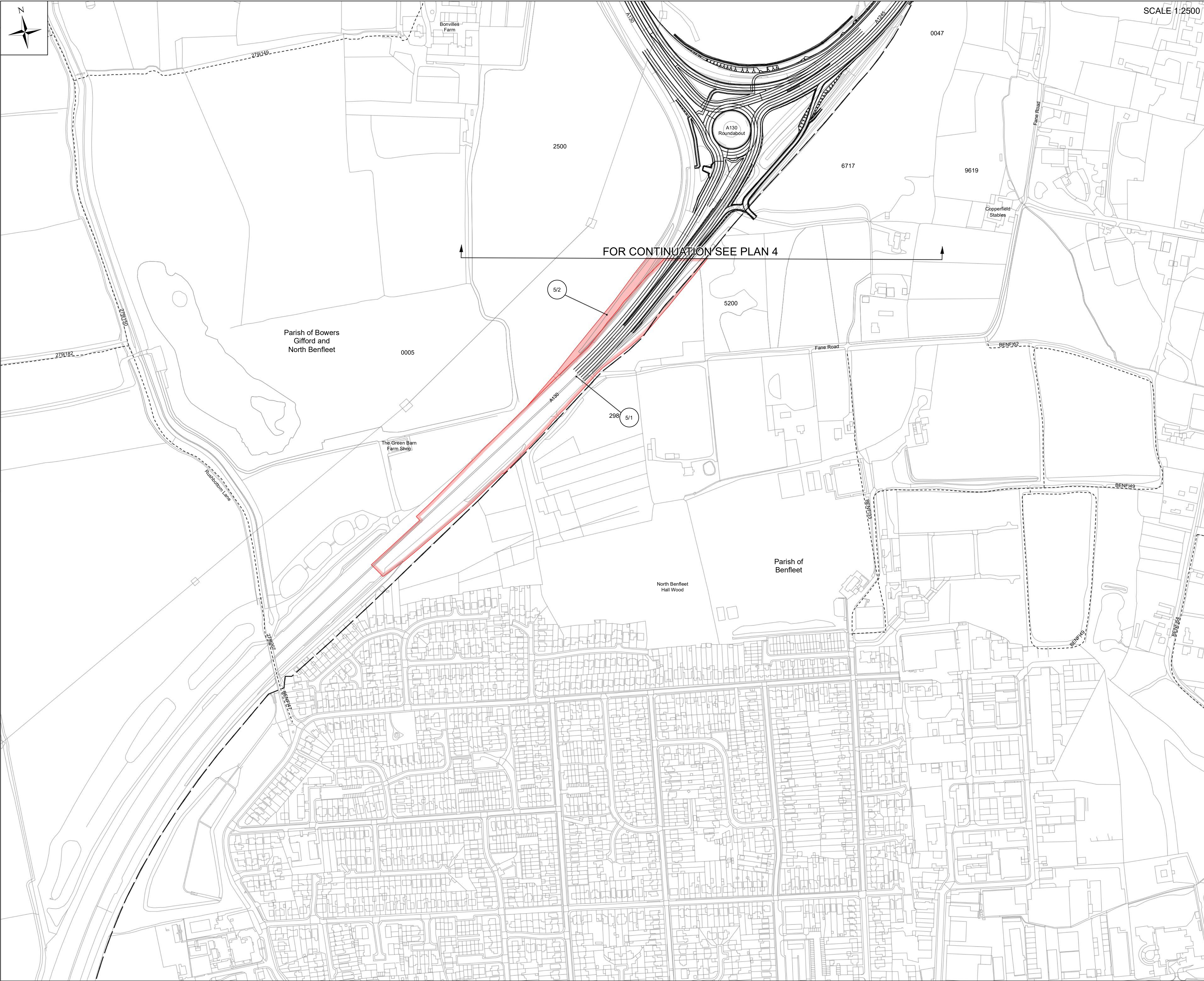

**LOCATION PLAN**

**KEY:**

- Title
- Title mitigation
- Easement (S250 right)
- Essential licence
- Title (private means of access)
- Licence (private means of access)
- Land in ownership of Acquiring Authority
- Parish boundary
- Public right of way

0 50 100 150 200 250 m

SCALE 1:2,500 @ A1

This map is reproduced from Ordnance Survey material with the permission of Ordnance Survey on behalf of the Controller of Her Majesty's Stationery Office. Crown Copyright and database rights 2019. OS 100030848. Unauthorised reproduction infringes Crown Copyright and may lead to prosecution or civil proceedings. Highways England.

Rev	Date	Description of revision	Drawn	Checked	Reviewed	Approved
R0	11/02/20	FIRST REVISION	RJ	ME	RT	GI
R1	11/09/20	REVISED FROM LEGAL REVIEW	RJ	ME	RT	GI
R2	11/11/20	REVISED FROM LEGAL REVIEW	RJ	ME	RT	GI

DRAWING STATUS

**CONSULTATION**

**Essex Highways**

Essex Highways, Seax House, Victoria Road South,  
Chelmsford, CM1 1QH.  
Tel: 0345 6037631 © Essex County Council

SCHEME TITLE

**A127 FAIRGLEN INTERCHANGE**

DRAWING TITLE

**LAND REFERENCE PLAN**

**SITE PLAN 5 OF 6**

DESIGNED	DRAWN	CHECKED	REVIEWED	APPROVED
SR	RJ	ME	RT	GI
DATE	DATE	DATE	DATE	DATE
NOV 20	NOV 20	NOV 20	NOV 20	NOV 20

SCALE (AT A1)

1:2,500 DO NOT SCALE

DRAWING No. **B3553T26\_Land\_Reference\_Plan\_Sheet\_5** REV. **R2**





**LOCATION PLAN**

**KEY:**

- Title
- Title mitigation
- Easement (S250 right)
- Essential licence
- Title (private means of access)
- Licence (private means of access)
- Land in ownership of Acquiring Authority
- Parish boundary
- Public right of way

SCALE 1:2,500 @ A1

This map is reproduced from Ordnance Survey material with the permission of Ordnance Survey on behalf of the Controller of Her Majesty's Stationary Office. Crown Copyright and database rights 2019. OS 100030646. Unauthorised reproduction infringes Crown Copyright and may lead to prosecution or civil proceedings. Highways England.

Rev	Date	Description of revision	Drawn	Checked	Reviewed	Approved
R0	11/02/20	FIRST REVISION	RJ	ME	RT	GI
R1	11/09/20	REVISED FROM LEGAL REVIEW	RJ	ME	RT	GI
R2	11/11/20	REVISED FROM LEGAL REVIEW	RJ	ME	RT	GI

**DRAWING STATUS**

**CONSULTATION**

Essex Highways, Seax House, Victoria Road South,  
Chelmsford, CM1 1QH.  
Tel: 0345 6037631

© Essex County Council

**SCHEME TITLE**

**A127 FAIRGLEN INTERCHANGE**

**DRAWING TITLE**

**LAND REFERENCE PLAN**

**SITE PLAN 6 OF 6**

DESIGNED	DRAWN	CHECKED	REVIEWED	APPROVED
SR	RJ	ME	RT	GI
DATE	DATE	DATE	DATE	DATE
NOV 20	NOV 20	NOV 20	NOV 20	NOV 20

SCALE (AT A1)

1:2,500

DO NOT SCALE

DRAWING No. **B3553T26\_Land\_Reference\_Plan\_Sheet\_6**

REV. **R2**

integrated expertise